

1. Cutting Plate Lifting group

During the season 2014/2015 some claims have arisen from the market concerning the breakage of axle for cutting deck lifting (**Pic.1, part 21**).

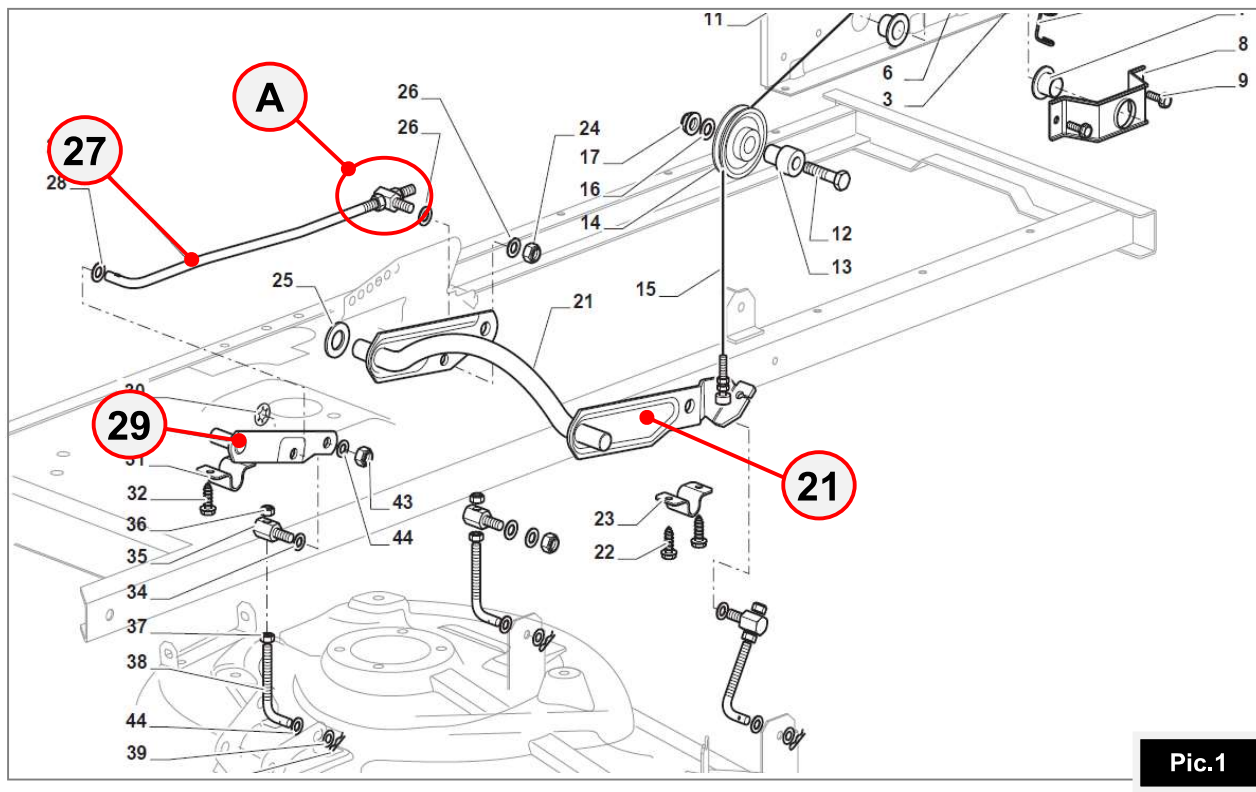

1.a – Connecting rod between lever and axle for cutting deck lifting (**Pic.2, part 27**)

The rod diameter of the rod has been increased from 6.8 to 9 mm and the adjustment pin removed (**Pic.1, part A**) since the adjustment of longitudinal position of the cutting deck has never been necessary. In **Pic. 2** you can see the "new" connection between the front lever and rear lifting axle.

